

POWERFLEX®

PART NUMBER

PFR5-6032

DESCRIPTION

REAR DIFF MOUNT FRONT MOUNTING BUSH

INSTALLATION GUIDE

Contents (parts per pack):

2 x Polyurethane A Bushes	2 x Polyurethane B Bushes
2 x Stainless Steel Sleeves	1 x PTFE/Silicone Grease
2 x Zinc Plated Mild Steel Washers	2 x Black Anodised Washers

Please read the complete fitting instructions and check package components before fitment. These fitting instructions are to be used as a guide and in conjunction with workshop manual.

It is recommended that:

- all work to be carried out by a licensed technician;
- all safety precautions adhered to;
- wheel alignment to be checked and adjusted as required after any suspension work.
- All fasteners must be tensioned to manufacturer's torque settings.



Fitting Instructions:

1. Remove the original bush and clean away any dirt and corrosion, remembering to also file away any sharp edges.
2. Insert the polyurethane bushes onto opposite ends of the bore of the subframe, ensuring the top hats of each bush is flush to the subframe, and that the bushes are fully inserted into the bore.
3. Apply some of the supplied grease to the outer surface of the stainless steel sleeve, and insert it into the bore of the polyurethane bushes, ensuring it sits flush.
4. Insert the black anodised washers into the recess of each polyurethane bush, with the filleted edge going in first, until it sits flush within the recess.
5. Place the zinc plated mild steel washer on the end faces of the polyurethane bushes and refit the subframe, remembering to tension all hardware to manufacturers recommended torque settings.

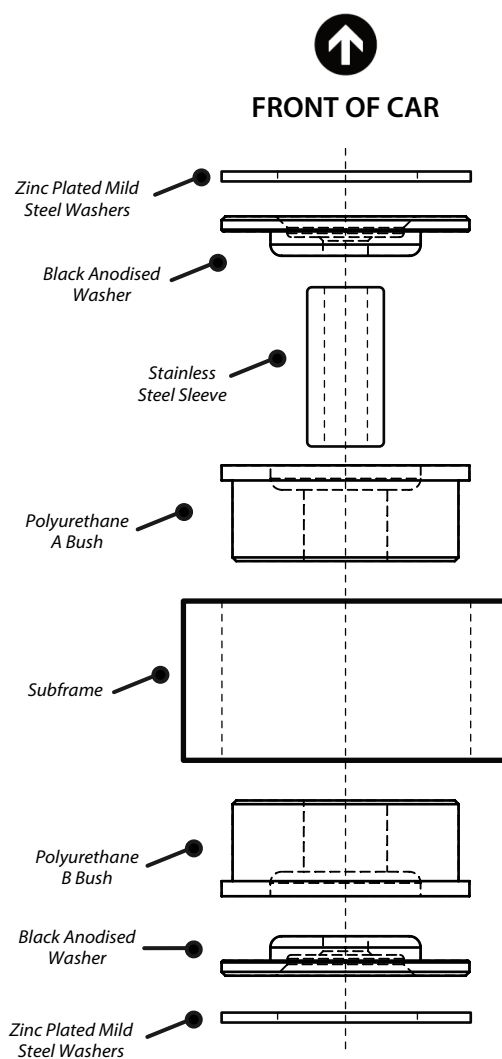

Figure 1